

### Environment

<b>Conforming to standards</b>		IEC 947-5-1, EN 60947-5-1 EN 60204-1, EN 60204-32, EN 292-2, EN 418
<b>Product certifications</b>		UL type 4X A600-Q600, CSA type 4 A600-Q600
<b>Protective treatment</b>	Standard version	“TH”
<b>Ambient air temperature</b>	Storage	°C - 40...+ 70
	Operation	°C - 25...+ 70
<b>Vibration resistance</b>	Conforming to IEC 68-2-6	15 gn (10...500 Hz)
<b>Shock resistance</b>	Conforming to IEC 68-2-27	100 gn
<b>Electric shock protection</b>	Conforming to IEC 536 and NF C 20-030	Class II
<b>Degree of protection</b>	Conforming to IEC 529	IP 65
	Conforming to EN 50102	IK 08
<b>Mechanical durability</b>	Operating cycles	1 million
<b>Enclosure</b>		Double insulated polypropylene, coloured yellow throughout
<b>Cable entry</b>		Rubber sleeve with stepped entry diameter for cable Ø 7...Ø 15 mm

### Contact block characteristics

<b>Rated operational characteristics</b>	Conforming to IEC 947-5-1 Appendix A	$\sim$ AC-15: A 600 ou Ue = 600 V, Ie = 1.2 A ou Ue = 240 V, Ie = 3 A $\equiv$ DC-13: Q 600 ou Ue = 600 V, Ie = 0.1 A ou Ue = 250 V, Ie = 0.27 A
<b>Thermal current (Ithe)</b>		<b>A</b> 10
<b>Rated insulation voltage (Ui)</b>	Conforming to IEC/EN 60947-1	<b>V</b> 600, degree of pollution 3
<b>Rated impulse withstand voltage (Uimp)</b>	Conforming to IEC/EN 60947-1	<b>kV</b> 6
<b>Positive operation</b>	Conforming to IEC/EN 60947-5-1 Section 3	Mushroom head pushbutton: N/C contact with positive opening operation
<b>Contact operation</b>		Slow break
<b>Resistance across terminals</b>		<b>mΩ</b> ≤ 25
<b>Operating force</b>		<b>N</b> 13...15
<b>Terminal referencing</b>	Conforming to CENELEC EN 50013	By numbers
<b>Short-circuit protection</b>		10 A cartridge fuse type gG (gl)
<b>Cabling</b>		<b>mm<sup>2</sup></b> Scew and captive cable clamp terminals. Capacity: 1 x 2.5 ou 2 x 1.5 with or without cable end
<b>Rated operational power</b>	Conforming to IEC 947-5-1	Appendix C
	Utilisation categories	AC-15 and DC-13
	Operating rate	3600 operating cycles/hour Load factor: 0.5

**a.c. supply**  $\sim$  50-60 Hz

$\sim$  Inductive circuit

**d.c. supply**  $\equiv$

power broken in W  
for 1 million operating cycles

Voltage	V	<b>24</b>	<b>48</b>	<b>120</b>
$\sim$	W	65	48	40

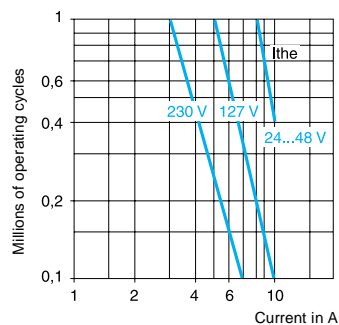

# Components for safety applications

## Pendant control stations

Double insulated with intuitive operation, type XAC A "Pistol grip", for control circuits

**For control of single-speed hoist motors** 



XAC A2014

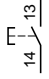
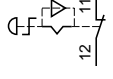
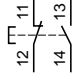
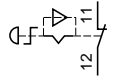
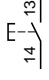
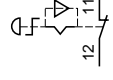
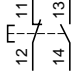
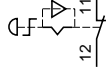

XAC A2114

Number of operators	Type of operators	Contact blocks and scheme		Reference	Weight kg
		Per direction	Emergency stop		
2 mechanically interlocked + 1 trigger action latching Ø 30 mm Emergency Stop operator ZA2 BS834	Standard	1 N/O ZB2 BE101	1 N/C ZB2 BE102	<b>XAC A2014</b>	0.310
					
		1 N/C + 1 N/O ZB2 BE102 + ZB2 BE101	1 N/C ZB2 BE102	<b>XAC A2054</b>	0.340
					
	Booted	1 N/O ZB2 BE101	1 N/C ZB2 BE102	<b>XAC A2114</b>	0.310
					
		1 N/C + 1 N/O ZB2 BE102 + ZB2 BE 101	1 N/C ZB2 BE102	<b>XAC A2154</b>	0.340
					

# Components for safety applications

## Pendant control stations

Double insulated with intuitive operation, type XAC A "Pistol grip", for control circuits



XAC A2074



XAC A2174



XAC A921



XAC A923

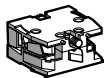

BZ2 BE

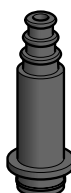

XAC A913

### For control of 2-speed hoist motors

Number of operators	Type of operators	Contact blocks and scheme		Reference	Weight kg
		Per direction	Emergency stop		
2 mechanically interlocked + 1 trigger action latching Ø 30 mm Emergency Stop operator ZA2 BS834	Standard	2 step 1N/O + 1 N/O staggered ZB2 BE101 + ZB2 BE201	1 N/C ZB2 BE102	XAC A2074	0.360
	Booted	2 step 1 N/O + 1 N/O staggered ZB2 BE101 + ZB2 BE201	1 N/C ZB2 BE102		

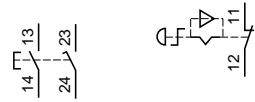
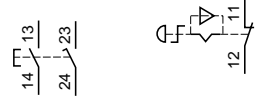

### Accessories and spare parts

Description	Application	Marking/Function	Scheme	Reference	Weight kg
Booted pushbutton operators with fixing screws	XAC A211● XAC A215● (Single-speed)	↑	—	XAC A921	0.010
		↓	—	XAC A922	0.010
	XAC A217● (2 speed)	▲	—	XAC A923	0.010
		▼	—	XAC A924	0.010
Contact blocks spring return, slow break	XAC A all models	N/O		ZB2 BE101	0.015
		N/C		ZB2 BE102	0.015
		N/O staggered		ZB2 BE201	0.015
Protective cable sleeve + suspension ring + cable clamp	Cable Ø 7 to 13 mm	—	—	XAC A913	0.070

### Dimensions

XAC A2●●●

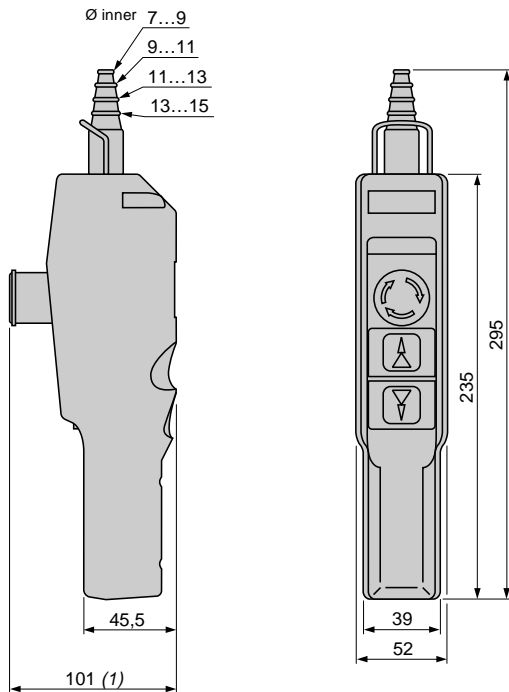

(1) With trigger action latching Ø 30 mm Emergency stop ZA2 BS834.

### Schemes (typical application examples)

For single-speed reversing motor

XAC A2●1●

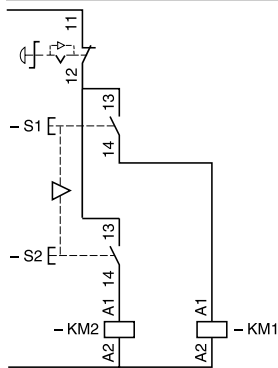

XAC A2●5●

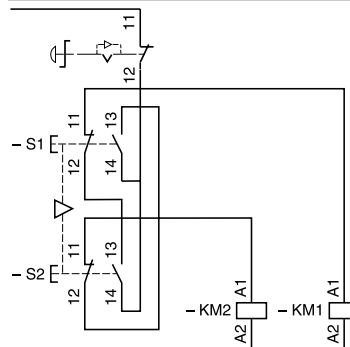

For 2-speed reversing motor

AC A2●7●

